

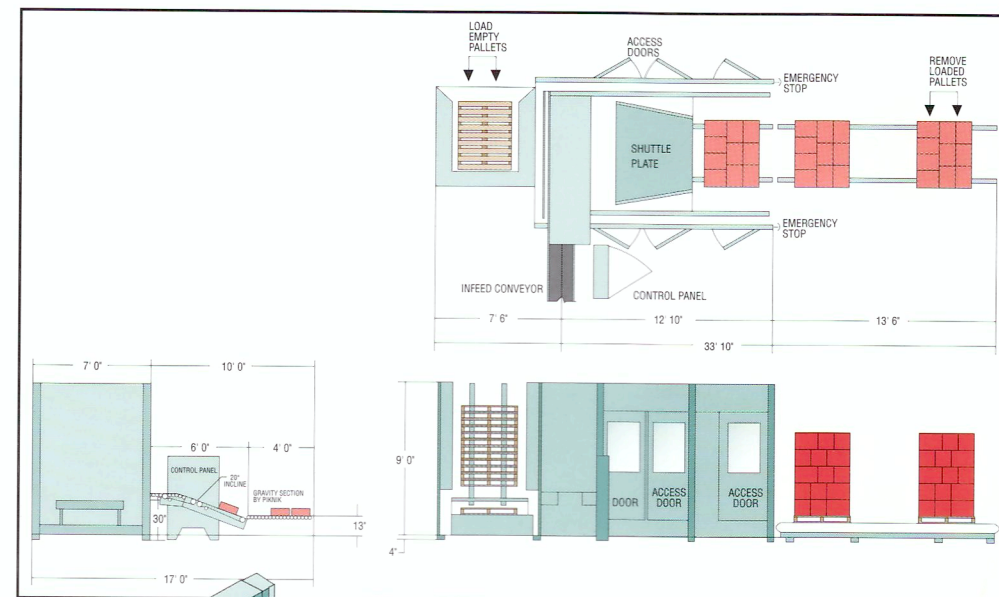

PRODUCTION
AUTOMATION

**FLOOR LEVEL
AUTOMATIC
PALLETIZER**



PRODUCTION
AUTOMATION
2600
FLOOR LEVEL
AUTOMATIC
PALLETIZER

Production Automation (PAI) continues its pace-setting reputation for reliable high speed material handling with the Series 2600 palletizer. This floor level model consistently achieves speeds up to 50 cases per minute, depending on pattern and number of cases per load. Compare that to our competitors' claim of 20 cases per minute, and the benefits and cost savings of the Series 2600 are obvious.

Backed by more than 100 combined years of palletizer engineering experience, the Series 2600 is heavy duty equipment built for high performance, ease of operation and low maintenance. Its shuttle adaptation for running multiple lines is but one example of innovative design and operational flexibility.

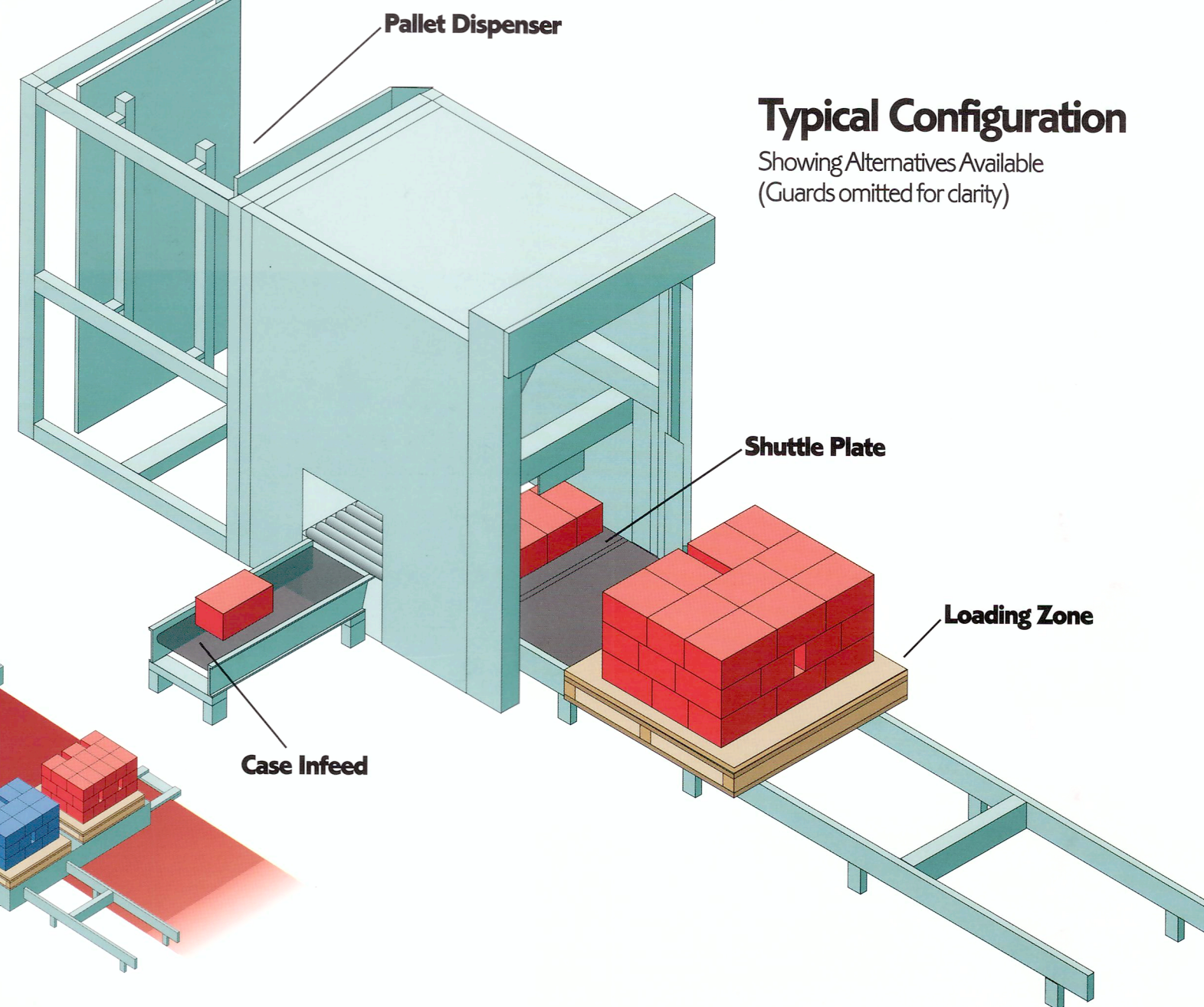

Typical Configuration

Showing Alternatives Available
(Guards omitted for clarity)

**Multiple line
shuttle option**